

WASHERS, SHOULDER WASHERS & SCREW INSULATORS

SECTION IV

New
SIZES

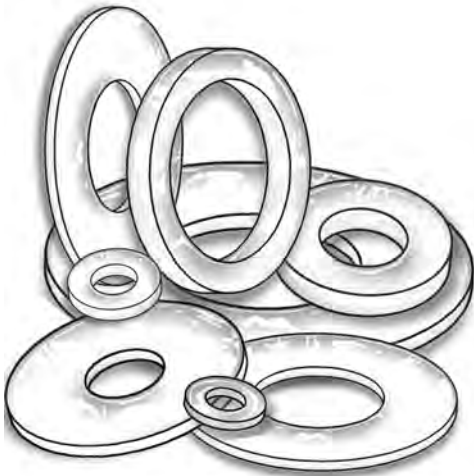
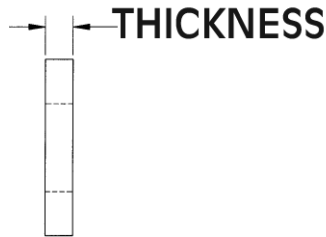
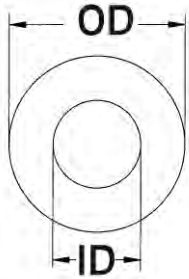

SPECIAL FLAT WASHERS

Molded in **Natural Nylon 6/6**

ITEM NUMBER	DESCRIPTION	OD	ID	THICKNESS
17W00850	W 850	.085 (2,16)	.032 (0,81)	.062 (1,57)
17W00901	W 901	.090 (2,29)	.031 (0,79)	.031 (0,79)
17W01001	W 1001	.100 (2,54)	.035 (0,89)	.020 (0,51)
17W01010	W 1010	.125 (3,17)	.047 (1,19)	.125 (3,17)
17W01011	W 1011	.125 (3,18)	.032 (0,81)	.060 (1,57)
17W01012	W 1012	.120 (3,05)	.063 (1,60)	.180 (4,57)
17W01013	W 1013	.120 (3,05)	.045 (1,14)	.130 (3,30)
17W01014	W 1014	.120 (3,05)	.055 (1,40)	.080 (2,03)
17W01015	W 1015	.120 (3,05)	.090 (2,29)	.180 (4,57)
17W01016	W 1016	.125 (3,18)	.059 (1,50)	.125 (3,18)
17W01017	W 1017	.125 (3,18)	.070 (1,78)	.090 (2,29)
17W01018	W 1018	.127 (3,23)	.065 (1,65)	.040 (1,02)
17W01019	W 1019	.125 (3,17)	.070 (1,77)	.062 (1,57)
17W01020	W 1020	.125 (3,17)	.091 (2,31)	.125 (3,18)
17W01021	W 1021	.120 (3,04)	.062 (1,57)	.079 (2,00)
17W01022	W 1022	.125 (3,17)	.064 (1,62)	.312 (7,92)
17W01023	W 1023	.125 (3,18)	.062 (1,57)	.080 (2,03)
17W01045	W 1045	.156 (3,96)	.031 (0,79)	.062 (1,57)
17W01381	W 1381	.138 (3,51)	.040 (1,02)	.033 (0,84)
17W01480	W 1480	.148 (3,76)	.085 (2,16)	.062 (1,57)
17W01481	W 1481	.145 (3,68)	.071 (1,80)	.067 (1,70)
17W01550	W 1550	.150 (3,81)	.094 (2,38)	.035 (0,88)
17W01551	W 1551	.195 (4,95)	.110 (2,79)	.057 (1,44)
17W01552	W 1552	.257 (6,52)	.169 (4,29)	.063 (1,60)
17W01560	W 1560	.156 (3,96)	.050 (1,27)	.200 (5,08)
17W01561	W 1561	.156 (3,96)	.085 (2,16)	.200 (5,08)
17W01562	W 1562	.156 (3,96)	.091 (2,31)	.250 (6,35)
17W01566	W 1566	.156 (3,96)	.076 (1,93)	.062 (1,57)
17W01581	W 1581	.158 (4,01)	.110 (2,79)	.070 (1,79)
17W01582	W 1582	.157 (3,99)	.102 (2,59)	.098 (2,49)
17W01701	W 1701	.170 (4,32)	.038 (0,97)	.060 (1,52)
17W01702	W 1702	.182 (4,62)	.120 (3,05)	.125 (3,17)
17W01783	W 1783	.167 (4,24)	.106 (2,69)	.039 (0,99)
17W01784	W 1784	.178 (4,52)	.098 (2,49)	.045 (1,14)
17W01785	W 1785	.170 (4,32)	.110 (2,79)	.020 (0,51)
17W01786	W 1786	.165 (4,19)	.085 (2,15)	.056 (1,42)
17W01790	W 1790	.177 (4,49)	.112 (2,84)	.118 (2,99)
17W01791	W 1791	.179 (4,55)	.065 (1,65)	.078 (1,98)
17W01801	W 1801	.187 (4,75)	.125 (3,18)	.050 (1,27)
17W01802	W 1802	.180 (4,57)	.139 (3,53)	.064 (1,63)
17W01803	W 1803	.186 (4,72)	.098 (2,49)	.030 (1,02)
17W01804	W 1804	.187 (4,75)	.120 (3,05)	.060 (1,52)
17W01805	W 1805	.187 (4,75)	.086 (2,18)	.130 (3,30)
17W01806	W 1806	.187 (4,75)	.145 (3,68)	.050 (1,27)
17W01807	W 1807	.187 (4,75)	.120 (3,05)	.032 (0,81)
17W01809	W 1809	.187 (4,75)	.141 (3,58)	.125 (3,18)
17W01811	W 1811	.187 (4,75)	.115 (2,92)	.165 (4,19)
17W01812	W 1812	.188 (4,78)	.089 (2,26)	.141 (3,58)
17W01813	W 1813	.187 (4,75)	.116 (2,95)	.109 (2,77)
17W01814	W 1814	.188 (4,78)	.115 (2,92)	.040 (1,02)
17W01815	W 1815	.190 (4,83)	.094 (2,39)	.020 (0,51)
17W01816	W 1816	.187 (4,74)	.093 (2,36)	.078 (1,98)
17W01825	W 1825	.196 (4,98)	.085 (2,16)	.031 (0,79)
17W01870	W 1870	.187 (4,75)	.120 (3,05)	.062 (1,57)
17W01871	W 1871	.185 (4,70)	.051 (1,30)	.132 (3,35)

