

# SCREWS, BOLTS, & THREADED ROD

**METRIC Sizes  
Also Available**  
Page 261

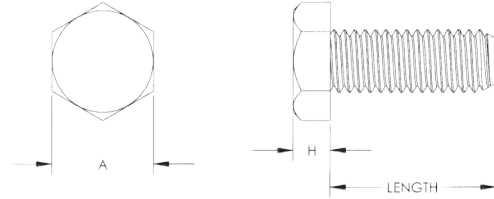

SCREW SIZE	A	H
0	.120-.125	.040-.048
2	.120-.125	.040-.050
3	.181-.188	.044-.055
4	.181-.188	.049-.060
6	.244-.250	.080-.093
8	.244-.250	.095-.110
10	.305-.312	.105-.120
1/4	.367-.375	.172-.190

## HEX UNSLOTTED HEADSTYLE

**Molded in Natural Nylon 6/6**

PART NUMBER	SCREW SIZE	THREAD	LENGTH
010080H012	0	0-80	1/8
010080H018	0	0-80	3/16
010080H025	0	0-80	1/4
010256H009	2	256	3/32
010256H012	2	256	1/8
010256H015	2	256	5/32
010256H018	2	256	3/16
010256H025	2	256	1/4
010256H028	2	256	9/32
010256H031	2	256	5/16
010256H037	2	256	3/8
010256H039	2	256	25/64
010256H043	2	256	7/16
010256H050	2	256	1/2
010256H056	2	256	9/16
010256H062	2	256	5/8
010256H075	2	256	3/4
010256H087	2	256	7/8
010256H100	2	256	1
010256H112	2	256	1 1/8
010264H018	2	264	3/16
010264H037	2	264	3/8
010348H012	3	348	1/8
010348H018	3	348	3/16
010348H025	3	348	1/4
010348H031	3	348	5/16
010348H037	3	348	3/8
010348H043	3	348	7/16
010348H050	3	348	1/2
010348H075	3	348	3/4
010356H031	3	356	5/16
010436H050	4	436	1/2
010440H009	4	440	3/32
010440H012	4	440	1/8
010440H014	4	440	9/64
010440H018	4	440	3/16
010440H025	4	440	1/4
010440H028	4	440	9/32
010440H031	4	440	5/16

PART NUMBER	SCREW SIZE	THREAD	LENGTH
010440H037	4	440	3/8
010440H043	4	440	7/16
010440H050	4	440	1/2
010440H056	4	440	9/16
010440H062	4	440	5/8
010440H068	4	440	11/16
010440H075	4	440	3/4
010440H087	4	440	7/8
010440H100	4	440	1
010440H112	4	440	1 1/8
010440H118	4	440	1 3/16
010440H125	4	440	1 1/4
010440H137	4	440	1 3/8
010440H150	4	440	1 1/2
010440H162	4	440	1 5/8
010440H175	4	440	1 3/4
010448H025	4	448	1/4
010632H009	6	632	3/32
010632H012	6	632	1/8
010632H015	6	632	5/32
010632H018	6	632	3/16
010632H025	6	632	1/4
010632H031	6	632	5/16
010632H037	6	632	3/8
010632H043	6	632	7/16
010632H050	6	632	1/2
010632H056	6	632	9/16
010632H062	6	632	5/8
010632H068	6	632	11/16
010632H075	6	632	3/4
010632H087	6	632	7/8
010632H100	6	632	1
010632H112	6	632	1 1/8
010632H125	6	632	1 1/4
010632H150	6	632	1 1/2
010632H162	6	632	1 5/8
010632H175	6	632	1 3/4
010632H187	6	632	1 7/8
010632H200	6	632	2

PART NUMBER	SCREW SIZE	THREAD	LENGTH
010632H225	6	632	2 1/4
010640H025	6	640	1/4
010640H037	6	640	3/8
010640H075	6	640	3/4
010640H100	6	640	1
010832H012	8	832	1/8
010832H018	8	832	3/16
010832H025	8	832	1/4
010832H028	8	832	9/32
010832H031	8	832	5/16
010832H037	8	832	3/8
010832H043	8	832	7/16
010832H050	8	832	1/2
010832H062	8	832	5/8
010832H075	8	832	3/4
010832H087	8	832	7/8
010832H100	8	832	1
010832H112	8	832	1 1/8
010832H125	8	832	1 1/4
010832H137	8	832	1 3/8
010832H150	8	832	1 1/2
010832H175	8	832	1 3/4
010832H187	8	832	1 7/8
010832H200	8	832	2
011024H012	10	1024	1/8
011024H018	10	1024	3/16
011024H025	10	1024	1/4
011024H031	10	1024	5/16
011024H037	10	1024	3/8
011024H050	10	1024	1/2
011024H062	10	1024	5/8
011024H075	10	1024	3/4
011024H100	10	1024	1
011024H125	10	1024	1 1/4
011024H150	10	1024	1 1/2
011032H012	10	1032	1/8
011032H018	10	1032	3/16
011032H025	10	1032	1/4
011032H031	10	1032	5/16

PART NUMBER	SCREW SIZE	THREAD	LENGTH
011032H037	10	1032	3/8
011032H043	10	1032	7/16
011032H050	10	1032	1/2
011032H062	10	1032	5/8
011032H075	10	1032	3/4
011032H081	10	1032	13/16
011032H087	10	1032	7/8
011032H100	10	1032	1
011032H106	10	1032	1 1/16
011032H125	10	1032	1 1/4
011032H150	10	1032	1 1/2
011032H175	10	1032	1 3/4
011032H200	10	1032	2
012520H025	1/4	1/4-20	1/4
012520H031	1/4	1/4-20	5/16
012520H037	1/4	1/4-20	3/8
012520H050	1/4	1/4-20	1/2
012520H062	1/4	1/4-20	5/8
012520H075	1/4	1/4-20	3/4
012520H087	1/4	1/4-20	7/8
012520H100	1/4	1/4-20	1
012520H125	1/4	1/4-20	1 1/4
012520H150	1/4	1/4-20	1 1/2
012520H175	1/4	1/4-20	1 3/4
012520H200	1/4	1/4-20	2
012520H250	1/4	1/4-20	2 1/2
012528H018	1/4	1/4-28	3/16
012528H025	1/4	1/4-28	1/4
012528H037	1/4	1/4-28	3/8
012528H062	1/4	1/4-28	5/8
012528H075	1/4	1/4-28	3/4
012528H100	1/4	1/4-28	1

