

## GROMMET NUTS

Molded in **Natural Nylon 6/6**

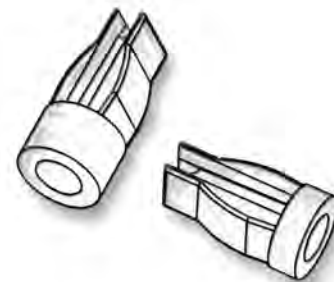
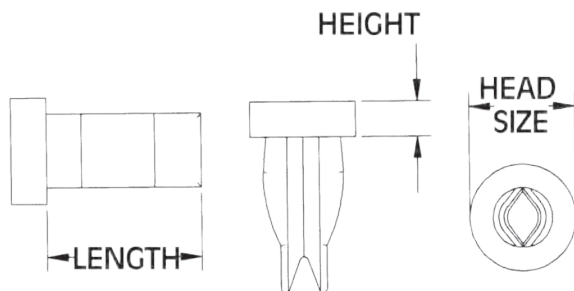

## CLOSED SCREW SPACER GROMMET NUTS

| PART NUMBER | HEIGHT      | HEAD SIZE   | HOLE SIZE RCT         | PANEL THICKNESS       | SCREW SIZE | LENGTH      |
|-------------|-------------|-------------|-----------------------|-----------------------|------------|-------------|
| 60SPG00001  | .125 (3,18) | 3/8" (9,53) | .270-.290 (6,86/7,37) | .020-.140 (0,51/3,56) | 8-10       | .548 (13,9) |
| 60SPG00002  | .187 (4,75) | 3/8" (9,53) | .270-.290 (6,86/7,37) | .020-.140 (0,51/3,56) | 8-10       | .548 (13,9) |
| 60SPG00003  | .250 (6,35) | 3/8" (9,53) | .270-.290 (6,86/7,37) | .020-.140 (0,51/3,56) | 8-10       | .548 (13,9) |
| 60SPG00004  | .312 (7,92) | 3/8" (9,53) | .270-.290 (6,86/7,37) | .020-.140 (0,51/3,56) | 8-10       | .548 (13,9) |
| 60SPG00005  | .375 (9,53) | 3/8" (9,53) | .270-.290 (6,86/7,37) | .020-.140 (0,51/3,56) | 8-10       | .548 (13,9) |
| 60SPG00006  | .500 (12,7) | 3/8" (9,53) | .270-.290 (6,86/7,37) | .020-.140 (0,51/3,56) | 8-10       | .548 (13,9) |

## PANEL CINCHING RIVETS

Molded in **Natural Nylon 6/6**

Micro Plastics' one-piece molded nylon panel cinching rivet consisting of two elements, the "T" shaped drive pin and "U" shaped body which are joined by thin webs. To install the fastener, insert the "U" shaped body into the panel hole and rap the head of the "T" shaped pin with a hammer or impact tool.

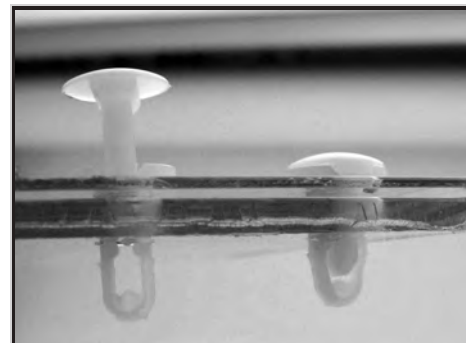
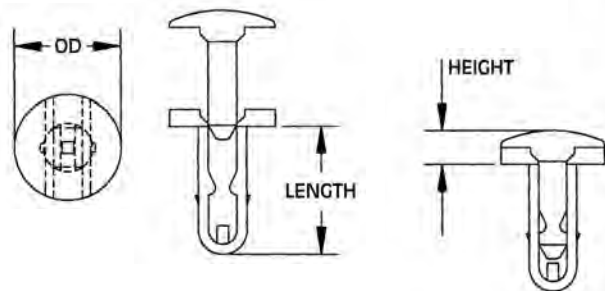
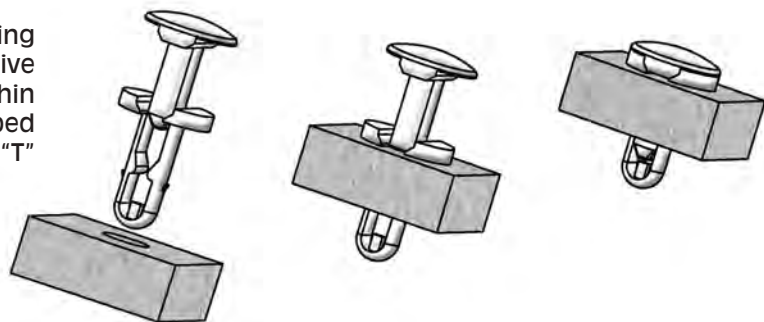

### Watch Instructional Video

[mms://www.microplastics.com/productvideos/PanelCinchingRivet.asf](https://www.microplastics.com/productvideos/PanelCinchingRivet.asf)

| PART NUMBER | HOLE SIZE   | PANEL THICKNESS         | OD           | LENGTH       | HEIGHT      |
|-------------|-------------|-------------------------|--------------|--------------|-------------|
| 27CINCH01   | .125 (3,18) | 0.020-0.109 (0,51-2,77) | 1/4" (6,35)  | .357 (9,07)  | .080 (2,03) |
| 27CINCH02   | .187 (4,75) | 0.020-0.174 (0,51-4,42) | 3/8" (9,53)  | .450 (11,08) | .120 (3,38) |
| 27CINCH03   | .250 (6,35) | 0.020-0.109 (0,51-2,77) | 3/8" (9,53)  | .475 (12,07) | .115 (2,92) |
| 27CINCH04   | .250 (6,35) | 0.020-0.174 (0,51-4,42) | 5/8" (15,88) | .555 (14,10) | .117 (2,97) |