

WIRE HANDLING HARDWARE

SECTION
VII

FIN CLIP PUSH MOUNTS

Molded in **Black U.V. Stabilized High Density Polyethylene**

"Fin clip push mounts" are available in 2 sizes for 3/16" and 1/4" diameter holes. The special head configuration allows use with beaded ties, as well as conventional cable ties. Parts are molded in black U.V. stabilized high density polyethylene, and are suitable for use in pre-drilled holes in wood, masonry, and a variety of other materials.



ITEM NUMBER	DESCRIPTION
23FCPM18765	3/16" (4,76) PUSH MOUNT

ITEM NUMBER	DESCRIPTION
23FCPM25095	1/4" (6,35) PUSH MOUNT

CABLE TIE MOUNT

Molded in **Natural Nylon 6/6**

Cable tie mount for use when both sides of the panel are accessible.

Watch Instructional Video
[mms://www.microplastics.com/productvideos/CableTieMount.asf](https://www.microplastics.com/productvideos/CableTieMount.asf)

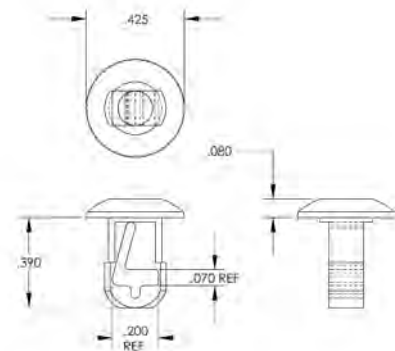
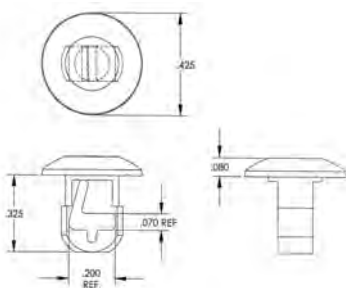

- PANEL HOLE DIAMETER .250
- MAXIMUM PANEL THICKNESS .125

- PANEL HOLE DIAMETER .250
- MAXIMUM PANEL THICKNESS .188

ITEM NUMBER	DESCRIPTION
23TA250125	Cable Tie Mount

ITEM NUMBER	DESCRIPTION
23TA250188	Cable Tie Mount