

CIRCUIT BOARD HARDWARE

SECTION VIII

STACKABLE SNAP-IN STANDOFF

Molded in **Natural Nylon 6/6**

Micro Plastics' stackable snap-in standoffs are available in #4, #6, and #8 screw sizes from 1/8" long to 1" long. Standoffs are molded in Nylon 6/6 material and are also available in UL94-VO Nylon. Part snaps into board and maintains spacing when screw is removed. Parts are stackable, self-aligning, and self-retaining to provide screw insulation in multi-level applications.

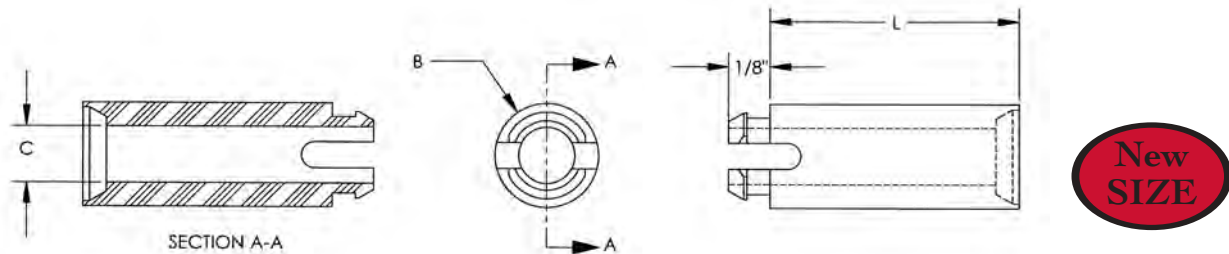
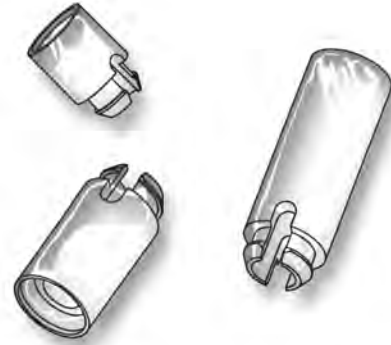

ITEM NUMBER	DESCRIPTION	SCREW SIZE	B	C	L	MOUNTING HOLE	PANEL THICKNESS
13STS004012	#4 X 1/8"	Snap-in Standoff #4	*.260 (6,60)	.125 (3,18)	1/8 (3,18)	.187 (4,75)	.062 (1,57)
13STS004018	#4 X 3/16"	Snap-in Standoff #4	*.260 (6,60)	.125 (3,18)	3/16 (4,75)	.187 (4,75)	.062 (1,57)
13STS004025	#4 X 1/4"	Snap-in Standoff #4	*.260 (6,60)	.125 (3,18)	1/4 (6,35)	.187 (4,75)	.062 (1,57)
13STS004031	#4 X 5/16"	Snap-in Standoff #4	*.260 (6,60)	.125 (3,18)	5/16 (7,94)	.187 (4,75)	.062 (1,57)
13STS004037	#4 X 3/8"	Snap-in Standoff #4	*.260 (6,60)	.125 (3,18)	3/8 (9,53)	.187 (4,75)	.062 (1,57)
13STS004043	#4 X 7/16"	Snap-in Standoff #4	*.260 (6,60)	.125 (3,18)	7/16 (11,11)	.187 (4,75)	.062 (1,57)
13STS004050	#4 X 1/2"	Snap-in Standoff #4	*.260 (6,60)	.125 (3,18)	1/2 (12,70)	.187 (4,75)	.062 (1,57)
13STS004062	#4 X 5/8"	Snap-in Standoff #4	*.260 (6,60)	.125 (3,18)	5/8 (15,88)	.187 (4,75)	.062 (1,57)
13STS004068	#4 X 11/16"	Snap-in Standoff #4	*.260 (6,60)	.125 (3,18)	11/16 (1,73)	.187 (4,75)	.062 (1,57)
13STS006025	#6 X 1/4"	Snap-in Standoff #6	5/16 (7,94)	.153 (3,88)	1/4 (6,35)	.234 (5,94)	.062 (1,57)
13STS006031	#6 X 5/16"	Snap-in Standoff #6	5/16 (7,94)	.153 (3,88)	5/16 (7,94)	.234 (5,94)	.062 (1,57)
13STS006037	#6 X 3/8"	Snap-in Standoff #6	5/16 (7,94)	.153 (3,88)	3/8 (9,53)	.234 (5,94)	.062 (1,57)
13STS006043	#6 X 7/16"	Snap-in Standoff #6	5/16 (7,94)	.153 (3,88)	7/16 (11,11)	.234 (5,94)	.062 (1,57)
13STS006050	#6 X 1/2"	Snap-in Standoff #6	5/16 (7,94)	.153 (3,88)	1/2 (12,70)	.234 (5,94)	.062 (1,57)
13STS006062	#6 X 5/8"	Snap-in Standoff #6	5/16 (7,94)	.153 (3,88)	5/8 (15,88)	.234 (5,94)	.062 (1,57)
13STS006075	#6 X 3/4"	Snap-in Standoff #6	5/16 (7,94)	.153 (3,88)	3/4 (19,05)	.234 (5,94)	.062 (1,57)
13STS006087	#6 X 7/8"	Snap-in Standoff #6	5/16 (7,94)	.153 (3,88)	7/8 (22,23)	.234 (5,94)	.062 (1,57)
13STS006100	#6 X 1"	Snap-in Standoff #6	5/16 (7,94)	.153 (3,88)	1 (25,40)	.234 (5,94)	.062 (1,57)
13STS008025	#8 X 1/4"	Snap-in Standoff #8	5/16 (7,94)	.169 (4,29)	1/4 (6,35)	.234 (5,94)	.062 (1,57)
13STS008031	#8 X 5/16"	Snap-in Standoff #8	5/16 (7,94)	.169 (4,29)	5/16 (7,94)	.234 (5,94)	.062 (1,57)
13STS008037	#8 X 3/8"	Snap-in Standoff #8	5/16 (7,94)	.169 (4,29)	3/8 (9,53)	.234 (5,94)	.062 (1,57)
13STS008043	#8 X 7/16"	Snap-in Standoff #8	5/16 (7,94)	.169 (4,29)	7/16 (11,11)	.234 (5,94)	.062 (1,57)
13STS008050	#8 X 1/2"	Snap-in Standoff #8	5/16 (7,94)	.169 (4,29)	1/2 (12,70)	.234 (5,94)	.062 (1,57)
13STS008062	#8 X 5/8"	Snap-in Standoff #8	5/16 (7,94)	.169 (4,29)	5/8 (15,88)	.234 (5,94)	.062 (1,57)
13STS008075	#8 X 3/4"	Snap-in Standoff #8	5/16 (7,94)	.169 (4,29)	3/4 (19,05)	.234 (5,94)	.062 (1,57)
13STS008087	#8 X 7/8"	Snap-in Standoff #8	5/16 (7,94)	.169 (4,29)	7/8 (22,23)	.234 (5,94)	.062 (1,57)
13STS008093	#8 X 1/8"	Snap-in Standoff #8	5/16 (7,94)	.169 (4,29)	15/16" (23,79)	.234 (5,94)	.062 (1,57)
13STS008100	#8 X 1"	Snap-in Standoff #8	5/16 (7,94)	.169 (4,29)	1 (25,40)	.234 (5,94)	.062 (1,57)