

# WASHERS, SHOULDER WASHERS & SCREW INSULATORS

## SECTION IV

**New  
SIZES**

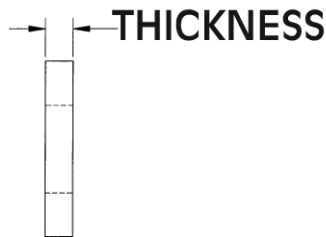
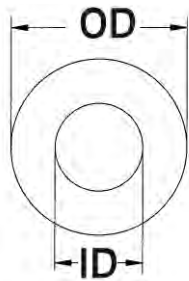

## SPECIAL FLAT WASHERS

Molded in **Natural Nylon 6/6**

ITEM NUMBER	DESCRIPTION	OD		ID		THICKNESS	
17W06203	W 6203	.620	(15,75)	.209	(5,31)	.180	(4,57)
17W06204	W 6204	.620	(15,75)	.350	(8,89)	.188	(4,78)
17W06205	W 6205	.625	(15,88)	.410	(10,41)	.033	(0,83)
17W06206	W 6206	.625	(15,88)	.260	(6,60)	.140	(3,56)
17W06207	W 6207	.625	(15,88)	.438	(11,12)	.032	(0,81)
17W06208	W 6208	.625	(15,87)	.260	(6,60)	.060	(1,52)
17W06221	W 6221	.622	(15,80)	.252	(6,40)	.060	(1,52)
17W06222	W 6222	.625	(15,88)	.250	(6,35)	.190	(4,83)
17W06240	W 6240	.625	(15,88)	.505	(12,83)	.092	(2,34)
17W06248	W 6248	.625	(15,88)	.330	(8,38)	.064	(1,63)
17W06249	W 6249	.625	(15,88)	.260	(6,60)	.180	(4,57)
17W06250	W 6250	.620	(15,75)	.165	(4,19)	.250	(6,35)
17W06251*	W 6251	.620	(15,87)	.301	(7,64)	.039	(0,99)
17W06252	W 6252	.625	(15,88)	.194	(4,93)	.125	(3,18)
17W06253	W 6253	.625	(15,88)	.187	(4,75)	.062	(1,57)
17W06254	W 6254	.625	(15,88)	.218	(5,54)	.062	(1,57)
17W06255	W 6255	.625	(15,88)	.250	(6,35)	.062	(1,57)
17W06256	W 6256	.625	(15,88)	.437	(11,10)	.093	(2,36)
17W06257	W 6257	.625	(15,88)	.125	(3,18)	.062	(1,57)
17W06258	W 6258	.625	(15,88)	.218	(5,54)	.125	(3,18)
17W06259	W 6259	.625	(15,88)	.218	(5,54)	.500	(12,70)
17W06260	W 6260	.625	(15,88)	.218	(5,54)	.250	(6,35)
17W06261	W 6261	.625	(15,88)	.390	(9,91)	.265	(6,73)
17W06262	W 6262	.625	(15,88)	.257	(6,53)	.020	(0,51)
17W06263	W 6263	.625	(15,88)	.281	(7,14)	.110	(2,79)
17W06264	W 6264	.625	(15,88)	.315	(8,00)	.031	(0,79)
17W06265	W 6265	.625	(15,88)	.422	(10,72)	.203	(5,16)
17W06266	W 6266	.625	(15,88)	.321	(8,15)	.125	(3,18)
17W06267	W 6267	.625	(15,88)	.218	(5,54)	.031	(0,79)
17W06268	W 6268	.625	(15,88)	.437	(11,10)	.250	(6,35)
17W06269	W 6269	5/8	(15,87)	.281	(7,14)	.210	(5,33)
17W06270	W 6270	.618	(15,70)	.270	(6,86)	.220	(5,59)
17W06271	W 6271	.630	(16,00)	.327	(8,31)	.071	(1,80)
17W06272	W 6272	.625	(15,88)	.385	(9,78)	.185	(4,70)
17W06273	W 6273	.625	(15,88)	.312	(7,92)	.250	(6,35)
17W06274	W 6274	.625	(15,88)	.284	(7,21)	.062	(1,57)
17W06275	W 6275	.625	(15,88)	.292	(7,42)	.040	(1,02)
17W06276	W 6276	.630	(16,00)	.355	(9,02)	.040	(1,02)
17W06277	W 6277	.625	(15,87)	.380	(9,65)	.050	(1,27)
17W06278	W 6278	.625	(15,87)	.320	(8,12)	.125	(3,17)
17W06279	W 6279	.625	(15,87)	.257	(6,52)	.100	(2,54)
17W06288	W 6288	.630	(16,00)	.394	(10,00)	.079	(2,00)
17W06289	W 6289	.625	(15,88)	.265	(6,73)	.093	(2,36)
17W06302	W 6302	.630	(16,00)	.171	(4,34)	.060	(1,52)
17W06303	W 6303	.638	(16,20)	.283	(7,19)	.077	(1,96)
17W06304	W 6304	.629	(15,98)	.437	(11,10)	.125	(3,18)
17W06305	W 6305	.630	(16,00)	.165	(4,19)	.118	(3,00)
17W06306	W 6306	.626	(15,90)	.182	(4,62)	.045	(1,14)
17W06310	W 6310	.630	(16,00)	.280	(7,11)	.030	(0,76)
17W06311	W 6311	.625	(15,87)	.260	(6,60)	.031	(0,78)
17W06365	W 6365	.636	(16,15)	.526	(13,36)	.098	(2,49)
17W06439	W 6439	.643	(16,33)	.510	(12,95)	.090	(2,29)
17W06440	W 6440	1.122	(28,50)	.644	(16,36)	.217	(5,51)
17W06470	W 6470	.647	(16,43)	.216	(5,48)	.031	(0,78)
17W06500	W 6500	.650	(16,51)	.440	(11,18)	.125	(3,18)

\* ID IS CHAMFERED

