

# UNIVERSAL NUTS

SECTION



STOCKED IN NYLON 6/6 UL 94V2 - CAN BE FURNISHED IN ACETAL

**METRIC Sizes  
Also Available**

Page 275



## WING NUTS

Molded in **Natural Nylon 6/6**

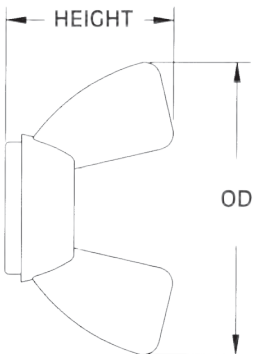
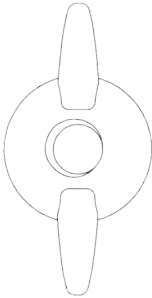

ITEM NUMBER	SCREW SIZE	THREAD	OD *REF.	HEIGHT
0600440WN	4	440	.90 (22,86)	.48 (12,19)
0600632WN	6	632	.90 (22,86)	.48 (12,19)
0600832WN	8	832	.90 (22,86)	.48 (12,19)
0601024WN	10	1024	.90 (22,86)	.48 (12,19)
0601032WN	10	1032	.90 (22,86)	.48 (12,19)
0601024WNA	10	1024	1.09 (27,69)	.63 (16,00)
0601032WNA	10	1032	1.09 (27,69)	.63 (16,00)
0625020WNA	1/4	1/4-20	1.090 (27,69)	.63 (16,00)
0625028WNA	1/4	1/4-28	1.09 (27,69)	.63 (16,00)
0625020WN	1/4	1/4-20	1.36 (34,54)	.71 (18,03)
0625028WN	1/4	1/4-28	1.36 (34,54)	.71 (18,03)
0631218WN	5/16	5/16-18	1.37 (34,80)	.72 (18,29)
0637516WN	3/8	3/8-16	1.37 (34,80)	.72 (18,29)
0637524WN	3/8	3/8-24	1.37 (34,80)	.72 (18,29)
0643714WN	7/16	7/16-14	1.76 (44,70)	.90 (22,86)
0650013WN	1/2	1/2-13	1.76 (44,70)	.90 (22,86)
0656212WN	9/16	9/16-12	1.76 (44,70)	.90 (22,86)

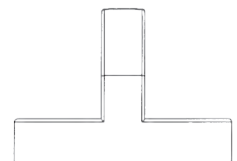
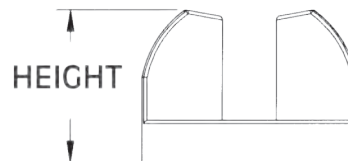
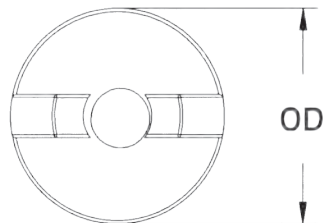

MATERIAL: CLEAR COPOLYESTER

CAN BE USED WITH TRANSPARENT POLYCARBONATE SCREWS

## CLEAR DECORATIVE WING NUT

Molded in **Clear Copolyester**



*Transparent*

ITEM NUMBER	SCREW SIZE	THREAD	OD	HEIGHT
0600832WNC	8	832	5/8 (15,87)	29/64 (11,50)
0601024WNC	10	1024	5/8 (15,87)	29/64 (11,50)
0601032WNC	10	1032	5/8 (15,87)	29/64 (11,50)
0625020WNC	1/4	1/4-20	5/8 (15,87)	29/64 (11,50)