

PANEL FASTENERS AND HOLE PLUGS

SECTION VI

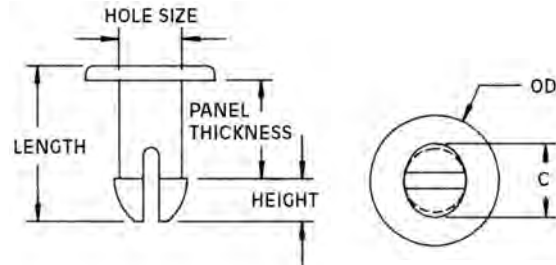

Micro Plastics' Push-in Fasteners provide an inexpensive, fast, convenient method to join plastic, light sheet metal, insulating materials, circuit boards, or any other thin, light-weight material. They can also be used as push-in glides or as bumpers. Special designed legs provide compression and expansion to lock fastener into pre-punched holes. These fasteners are vibration, abrasion and corrosion resistant, and feature large heads for easier assembly, and can be used over and over.



PUSH-IN-FASTENERS

Molded in **Natural Nylon 6/6**

| PART NUMBER | DESCRIPTION | OD | PANEL THICKNESS | HEIGHT | C | HOLE SIZE | LENGTH |
|-------------|-------------|---------------|-----------------|--------------|-------------|-------------|---------------|
| 27PIF0010 | PIF 10 | .500 (12,70) | .220 (5,59) | .110 (12,79) | .200 (5,08) | .148 (3,76) | .400 (10,16) |
| 27PIF0011 | PIF 11 | 13/64 (5,15) | .208 (5,28) | .083 (2,11) | .140 (3,56) | .115 (2,92) | .320 (8,13) |
| 27PIF0012 | PIF 12 | .175 (4,45) | .268 (6,81) | .090 (2,29) | .140 (3,56) | .096 (2,44) | .400 (10,16) |
| 27PIF0013 | PIF 13 | 3/16 (4,75) | .533 (13,54) | .087 (2,21) | .130 (3,30) | .095 (2,41) | .675 (17,15) |
| 27PIF0014 | PIF 14 | .248 (6,30) | .813 (20,65) | .140 (3,56) | .144 (3,66) | .110 (2,79) | 1.017 (25,83) |
| 27PIF0015 | PIF 15 | 21/64 (8,33) | .030 (0,76) | .130 (3,30) | .162 (4,12) | .152 (3,86) | .200 (5,08) |
| 27PIF0016 | PIF 16 | 11/16 (17,46) | .260 (6,60) | .265 (6,73) | .355 (9,02) | .288 (7,32) | .586 (14,88) |
| 27PIF0017 | PIF 17 | 11/32 (8,73) | .130 (3,30) | .110 (2,80) | .200 (5,08) | .160 (4,06) | .270 (6,86) |
| 27PIF0018 | PIF 18 | 13/64 (5,15) | .230 (5,84) | .098 (2,49) | .156 (3,96) | .128 (3,25) | .365 (9,27) |
| 27PIF0019 | PIF 19 | 1/4 (6,35) | .445 (11,30) | .085 (2,16) | .145 (3,68) | .095 (2,41) | .590 (14,99) |
| 27PIF0020 | PIF 20 | 15/64 (5,95) | .080 (2,03) | .080 (2,03) | .180 (4,57) | .124 (3,15) | .200 (5,08) |
| 27PIF0021 | PIF 21 | .186 (4,72) | .200 (5,08) | .065 (1,65) | .104 (2,64) | .080 (2,03) | .297 (7,54) |
| 27PIF0022 | PIF 22 | 1/2 (12,70) | .064 (1,63) | .185 (4,70) | .280 (7,11) | .243 (6,17) | .370 (9,40) |
| 27PIF0023 | PIF 23 | 3/16 (4,75) | .075 (1,91) | .060 (1,52) | .150 (3,81) | .120 (3,05) | .190 (4,83) |
| 27PIF0024 | PIF 24 | 19/32 (15,08) | .365 (9,27) | .187 (4,75) | .295 (7,49) | .245 (6,22) | .685 (17,40) |
| 27PIF0025 | PIF 25 | 15/64 (5,95) | 1.010 (25,65) | .082 (2,08) | .164 (4,17) | .124 (3,15) | 1.13 (28,70) |
| 27PIF0026 | PIF 26 | 15/64 (5,95) | .080 (2,03) | .070 (1,78) | .180 (4,57) | .124 (3,15) | .205 (5,21) |
| 27PIF0027 | PIF 27 | 3/8 (9,52) | 1.062 (26,97) | .177 (4,50) | .202 (5,13) | .165 (4,19) | 1.303 (28,32) |
| 27PIF0028 | PIF 28 | 11/32 (8,73) | .875 (22,23) | .174 (4,42) | .224 (5,69) | .175 (4,45) | 1.115 (28,32) |
| 27PIF0029 | PIF 29 | 13/64 (5,15) | .210 (5,33) | .091 (2,31) | .179 (4,55) | .130 (3,30) | .342 (8,69) |
| 27PIF0030 | PIF 30 | .135 (3,43) | .125 (3,18) | .070 (1,78) | .110 (2,79) | .089 (2,26) | .235 (5,97) |
| 27PIF0031 | PIF 31 | 25/64 (9,93) | .503 (12,78) | .210 (5,33) | .295 (7,49) | .230 (5,84) | 1.083 (27,51) |
| 27PIF0032 | PIF 32 | 13/64 (5,15) | .235 (5,97) | .066 (1,68) | .145 (3,68) | .115 (2,92) | .341 (8,66) |
| 27PIF0033 | PIF 33 | 3/8 (9,52) | .505 (12,83) | .130 (3,30) | .200 (5,08) | .160 (4,06) | .705 (17,91) |
| 27PIF0034 | PIF 34 | 3/4 (19,05) | .636 (16,15) | .180 (4,57) | .220 (5,59) | .180 (4,57) | .875 (22,23) |
| 27PIF0035 | PIF 35 | 5/16 (7,94) | .125 (3,18) | .070 (1,78) | .110 (2,80) | .089 (2,26) | .235 (5,96) |
| 27PIF0036 | PIF 36 | 3/16 (4,75) | .066 (1,68) | .075 (1,91) | .100 (2,54) | .090 (2,29) | .179 (4,55) |
| 27PIF0037 | PIF 37 | 3/8 (9,52) | .636 (16,15) | .180 (4,57) | .220 (5,59) | .180 (4,57) | .875 (22,22) |
| 27PIF0038* | PIF 38* | 9/32 (7,14) | .063 (1,60) | .078 (1,98) | .100 (2,54) | .093 (2,36) | .165 (4,19) |
| 27PIF0039 | PIF 39 | 1/4 (6,35) | .115 (2,92) | .085 (2,16) | .145 (3,68) | .093 (2,36) | .240 (6,10) |
| 27PIF0040* | PIF 40* | 9/32 (7,14) | .093 (2,36) | .068 (1,72) | .105 (2,67) | .093 (2,36) | .194 (4,92) |
| 27PIF0041* | PIF 41* | 5/16 (7,94) | .121 (3,07) | .085 (2,16) | .145 (3,68) | .089 (2,26) | .246 (6,25) |
| 27PIF0042 | PIF 42 | 13/64 (5,15) | .190 (4,83) | .090 (2,29) | .180 (4,57) | .130 (3,30) | .320 (8,13) |
| 27PIF0043 | PIF 43 | 13/64 (5,15) | .156 (3,96) | .135 (3,43) | .140 (3,56) | .115 (2,92) | .320 (8,13) |
| 27PIF0044 | PIF 44 | 13/64 (5,15) | .135 (3,43) | .135 (3,43) | .140 (3,56) | .115 (2,92) | .295 (7,49) |
| 27PIF0045 | PIF 45 | 13/64 (5,15) | .235 (5,97) | .070 (1,79) | .137 (3,48) | .115 (2,92) | .345 (8,76) |
| 27PIF0046 | PIF 46 | 13/64 (5,15) | .250 (6,35) | .106 (2,69) | .145 (3,68) | .115 (2,92) | .395 (10,03) |
| 27PIF0047 | PIF 47 | 13/64 (5,15) | .121 (3,07) | .105 (2,67) | .145 (3,68) | .115 (2,92) | .260 (6,60) |
| 27PIF0048 | PIF 48 | 25/64 (9,93) | .315 (8,00) | .113 (2,87) | .208 (5,28) | .160 (4,06) | .488 (12,40) |

PARTS WITH * HAVE NO SLOT -----"L" DIM.