

# WASHERS, SHOULDER WASHERS & SCREW INSULATORS

## SECTION IV

### SPECIAL FLAT WASHERS

Molded in **Natural Nylon 6/6**

**New  
SIZES**

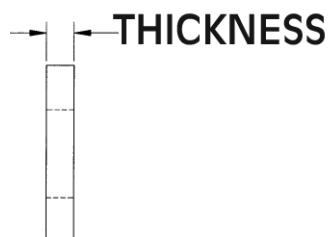
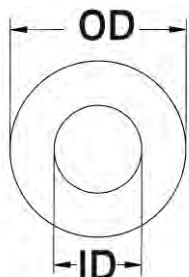

ITEM NUMBER	DESCRIPTION	OD	ID	THICKNESS
17W08650	W 8650	.865 (21,97)	.531 (13,49)	.200 (5,08)
17W08651	W 8651	.865 (21,97)	.688 (17,48)	.155 (3,94)
17W08652	W 8652	.875 (22,23)	.755 (19,18)	.125 (3,18)
17W08653	W 8653	.862 (21,89)	.690 (17,53)	.220 (5,59)
17W08655	W 8655	.856 (21,74)	.522 (13,25)	.098 (2,48)
17W08660	W 8660	.866 (21,97)	.413 (10,49)	.098 (2,49)
17W08661	W 8661	.876 (22,25)	.437 (11,10)	.502 (12,75)
17W08710	W 8710	.887 (22,52)	.797 (20,24)	.500 (12,70)
17W08711	W 8711	.871 (22,12)	.706 (17,93)	.111 (2,82)
17W08747	W 8747	.875 (22,22)	.532 (13,51)	.155 (3,93)
17W08748	W 8748	.878 (22,30)	.564 (14,33)	.062 (1,59)
17W08749	W 8749	.870 (22,10)	.506 (12,85)	.201 (5,11)
17W08751	W 8751	.875 (22,23)	.312 (7,92)	.125 (3,18)
17W08752	W 8752	.875 (22,23)	.408 (10,36)	.060 (1,52)
17W08753	W 8753	.875 (22,23)	.257 (6,53)	.031 (0,79)
17W08754	W 8754	.885 (22,48)	.343 (8,71)	.062 (1,57)
17W08755	W 8755	.855 (21,72)	.312 (7,92)	.125 (3,18)
17W08756	W 8756	.875 (22,23)	.500 (12,70)	.125 (3,18)
17W08757	W 8757	.875 (22,23)	.312 (7,92)	.187 (4,75)
17W08758	W 8758	.865 (21,97)	.340 (8,64)	.187 (4,75)
17W08759	W 8759	.875 (22,23)	.377 (9,58)	.062 (1,57)
17W08760	W 8760	.875 (22,23)	.380 (9,65)	.093 (2,36)
17W08761	W 8761	.875 (22,23)	.390 (9,91)	.093 (2,36)
17W08762	W 8762	.875 (22,23)	.257 (6,53)	.062 (1,57)
17W08763	W 8763	.875 (22,23)	.627 (15,93)	.114 (2,90)
17W08764	W 8764	7/8 (22,23)	.265 (6,73)	.093 (2,36)
17W08765	W 8765	.870 (22,10)	.531 (13,49)	.187 (4,75)
17W08767	W 8767	.860 (21,84)	.397 (10,08)	.165 (4,19)
17W08768	W 8768	.885 (22,48)	.390 (9,91)	.094 (2,39)
17W08769	W 8769	.875 (22,23)	.750 (19,05)	.160 (4,06)
17W08770	W 8770	.891 (22,63)	.780 (19,81)	.505 (12,83)
17W08771	W 8771	.875 (22,23)	.593 (15,08)	.145 (3,68)
17W08800	W 8800	.880 (22,35)	.390 (9,91)	.062 (1,57)
17W08801	W 8801	.872 (22,15)	.315 (8,00)	.062 (1,57)
17W08802	W 8802	.880 (22,35)	.485 (12,31)	.060 (1,52)
17W08803	W 8803	.882 (22,40)	.589 (14,96)	.085 (2,16)
17W08805	W 8805	.880 (22,35)	.690 (17,52)	.032 (0,81)
17W08806	W 8806	.885 (22,48)	.385 (9,78)	.062 (1,57)
17W08810	W 8810	.880 (22,35)	.500 (12,70)	.065 (1,65)
17W08812	W 8812	.880 (22,86)	.385 (9,78)	.125 (3,18)
17W08813	W 8813	.880 (22,35)	.327 (8,31)	.060 (1,52)
17W08901	W 8901	.890 (22,61)	.315 (8,00)	.215 (5,46)
17W08950	W 8950	.900 (22,86)	.255 (6,48)	.125 (3,18)
17W08951	W 8951	.890 (22,61)	.317 (8,05)	.245 (6,22)
17W08952	W 8952	.902 (22,91)	.244 (6,20)	.079 (2,01)
17W08953	W 8953	.900 (22,86)	.579 (14,71)	.075 (1,91)
17W08954	W 8954	.890 (22,60)	.400 (10,16)	.063 (1,60)
17W09000	W 9000	.900 (22,86)	.375 (9,53)	.055 (1,40)
17W09001	W 9001	.900 (22,86)	.500 (12,70)	.075 (1,91)
17W09002	W 9002	.900 (22,86)	.515 (13,08)	.060 (1,52)
17W09260	W 9260	.926 (23,52)	.705 (17,91)	.124 (3,15)
17W09282	W 9282	.970 (24,64)	.230 (5,84)	.125 (3,18)
17W09283	W 9283	1.005 (25,53)	.406 (10,31)	.080 (2,03)
17W09290	W 9290	.929 (23,60)	.472 (11,99)	.126 (3,20)
17W09320	W 9320	.932 (23,67)	.381 (9,68)	.031 (0,79)

