

THIS DOCUMENT IS THE PROPERTY OF KEYSTONE ELECTRONICS CORP. AND SHALL NOT BE REPRODUCED, DISTRIBUTED OR USED AS A BASIS FOR MANUFACTURE WITHOUT PRIOR WRITTEN PERMISSION FROM KEYSTONE ELECTRONICS CORP.

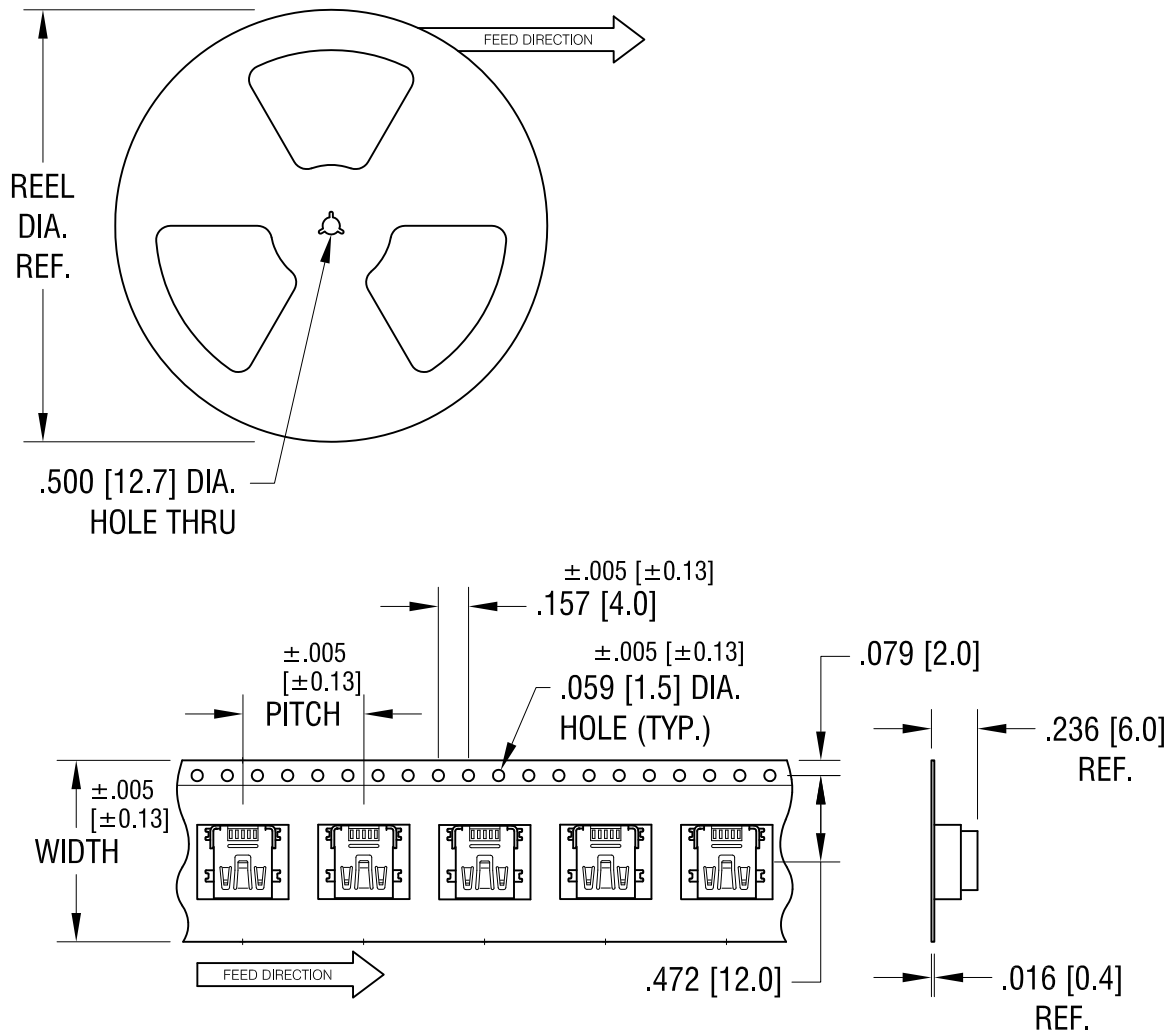

NOTES:

TAPE AND REEL SPECIFICATIONS:

1. TAPE:
 MAT'L - ALL CONDUCTIVE POLYSTYRENE CARRIER
 ANSI/EIA-481 STANDARD
 .945 [24.0] WIDE; .630 [16.0] PITCH
2. REEL:
 15.0 [380.8] DIA. 1000 PIECES OF
 PART NO. 934 PER REEL.
3. MYLAR TAPE ADDED TO
 TOP SURFACE OF EACH PART

5.05.16	CHANGE AS PER ECN 16-052	C
7.09.12	CHANGE AS PER ECN 12-084	B
12.01.11	CHANGE AS PER ECN 11-160	A
DATE	DESCRIPTION	REV.

KEYSTONE ELECTRONICS CORP.			
www.keyelco.com • ASTORIA, N.Y. 11105-2017 • Tel (718) 956-8900			
PART NAME		USB MINI SOCKET ON TAPE	
MATERIAL		AS NOTED	
FINISH		DRN BY	DATE
AS NOTED		BOONE	12.19.06
		APP'D	SCALE
		LN	1X
TOLERANCES	INCH [MM]	CODE	DWG NO.
DECIMAL	± .015 [± 0.38]	C	934TR
ANGULAR	± 1°		
UNLESS OTHERWISE SPECIFIED			

DATE	DESCRIPTION	REV.
5.31.11	CHANGE AS PER ECN 11-075	A
3.21.16	CHANGE AS PER ECN 16-039	B

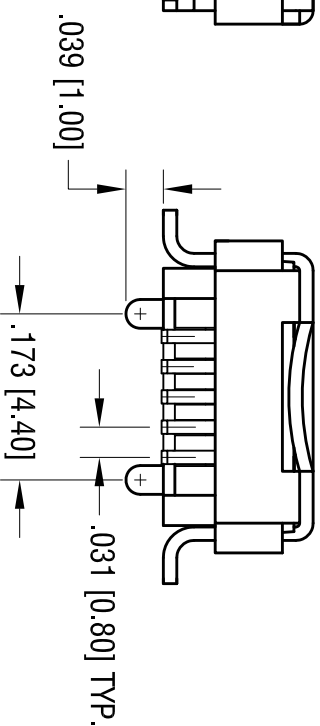
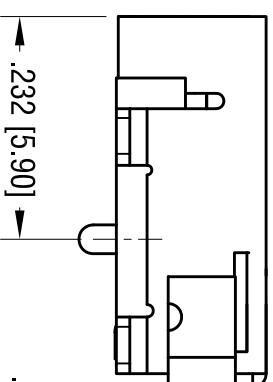
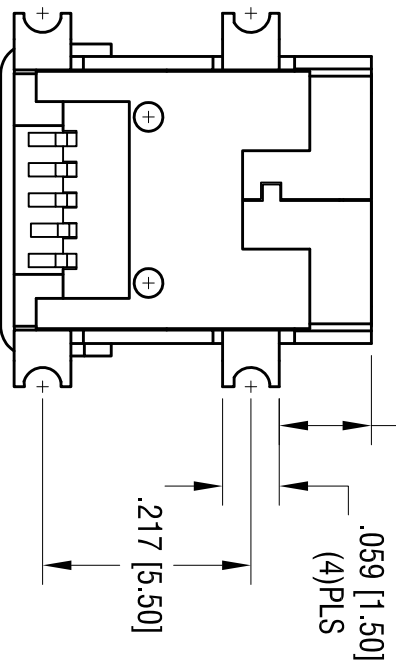
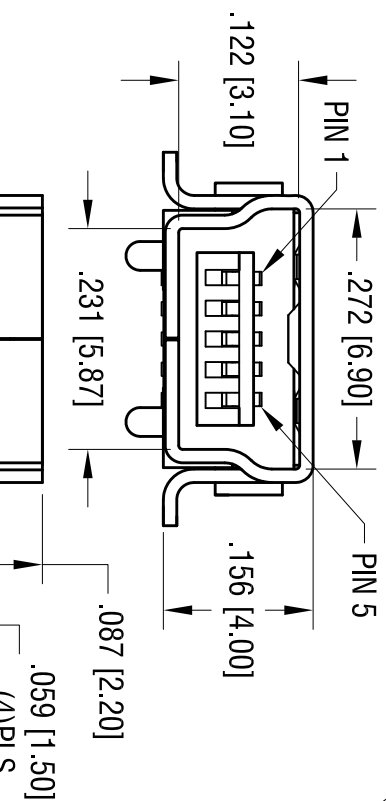
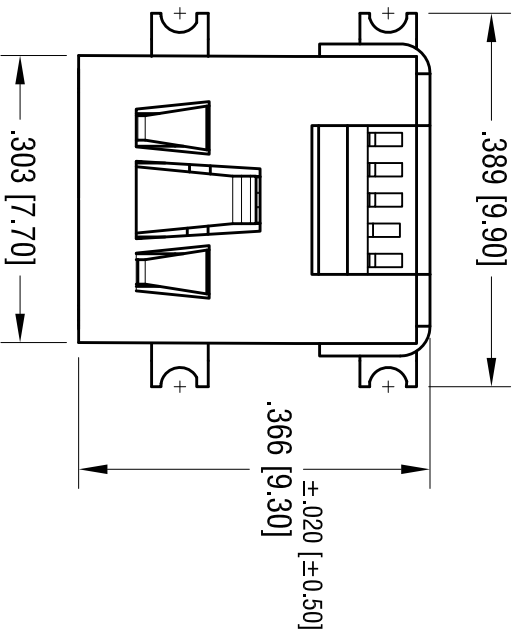
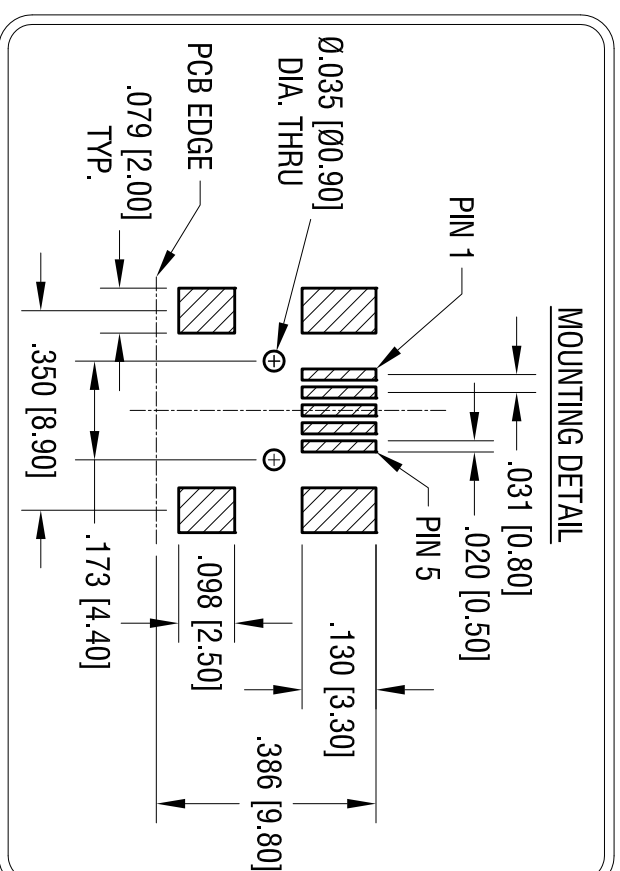

MOUNTING DETAIL

Notes:

- Shell: Mat'l: Brass, Finish: Nickel Plate
- Insulator: Mat'l: LCP
- Contact: Mat'l: Phosphor Bronze Finish: Gold Plate over Nickel on contact area. Tin Plate over nickel on solder Tail.

Electrical Specifications

- Contact Resistance: 50 milliohms Max.
- Insulation Resistance: 500 Mega Ohm.
- Dielectric Voltage: 100V AC max. current : 1 Amp



ACTUAL SIZE

THIS DOCUMENT IS THE PROPERTY OF KEYSTONE ELECTRONICS CORP. AND SHALL NOT BE REPRODUCED, DISTRIBUTED OR USED AS A BASIS FOR MANUFACTURE WITHOUT PRIOR WRITTEN PERMISSION FROM KEYSTONE ELECTRONICS CORP.

KEYSTONE ELECTRONICS CORP.			
www.kevelco.com • ASTORIA, N.Y. 11105-2017 • Tel (718) 956-8900			
PART NAME			
USB MINI TYPE HORIZONTAL SOCKET			
MATERIAL			
AS NOTED			
FINISH			
AS NOTED			
TOLERANCES		INCH	[MM]
DECIMAL	± .010	[± 0.25]	
ANGULAR	± 1°		
UNLESS OTHERWISE SPECIFIED		CODE	DWG NO.
		C	934
DRN BY	NT	DATE	12.17.08
APP'D	LN	SCALE	5X