

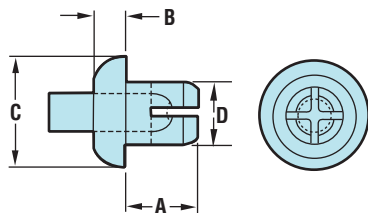

Heyco® Nylon Push Rivets

- 6/6 Nylon with a 94V-2 flammability rating; temperature index 257°F (105°C).
- Snaps into mounting holes with fingertip pressure—no tools required.
- Rivet legs expand to securely lock components into place.
- Pull head up to release and disassemble.

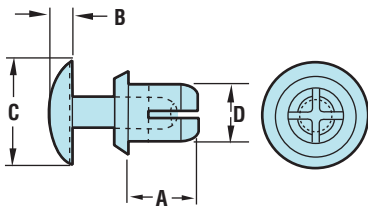

- 6/6 Nylon with a 94V-2 flammability rating; temperature index 257°F (105°C).
- Upon installation, the drive pin expands the rivet legs to lock components permanently and securely into place.
- Installation can be made "blind" from one side of the assembly.
- Resists vibration and corrosion.

HEAD STYLES

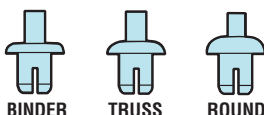

MOUNTING HOLE DIAMETER		PANEL THICKNESS		PART NO.		DESCRIPTION	PART DIMENSIONS									
							A Length		B Head Height		C Head Diameter		D Base Diameter			
in.	mm.	in.	mm.	in.	mm.	Black	White	in.	mm.	in.	mm.	in.	mm.			
.106	2,7	.039	1,0	.079	2,0	9020	9021	PR 106-039	.126	3,2	.055	1,4	.197	5,0	.102	2,6
		.082	2,1	.118	3,0	9022	9023	PR 106-082	.165	4,2						
		.106	2,7	.141	3,6	9024	9025	PR 106-106	.189	4,8						
		.134	3,4	.169	4,3	9026	9027	PR 106-134	.217	5,5						
.122	3,1	.039	1,0	.079	2,0	9028	9029	PR 122-039	.138	3,5	.063	1,6	.252	6,4	.118	3,0
		.079	2,0	.118	3,0	9030	9031	PR 122-079	.177	4,5						
		.118	3,0	.157	4,0	9032	9033	PR 122-118	.217	5,5						
		.157	4,0	.197	5,0	9034	9035	PR 122-157	.256	6,5						
.142	3,6	.217	5,5	.256	6,5	9038	9039	PR 122-217	.315	8,0	.063	1,6	.252	6,4	.138	4,0
		.086	2,2	.122	3,1	9046	9047	PR 142-086	.177	4,5						
		.106	2,7	.142	3,6	9048	9049	PR 142-106	.197	5,0						
		.126	3,2	.161	4,1	9050	9051	PR 142-126	.217	5,5						
.161	4,1	.185	4,7	.220	5,6	9054	9055	PR 142-185	.276	7,0	.071	1,8	.315	8,0	.157	4,0
		.098	2,5	.138	3,5	9058	9059	PR 161-098	.197	5,0						
		.138	3,5	.177	4,5	9060	9061	PR 161-138	.236	6,0						
		.177	4,5	.217	5,5	9062	9063	PR 161-177	.276	7,0						
.201	5,1	.217	5,5	.256	6,5	9064	9065	PR 161-217	.315	8,0	.087	2,2	.354	9,0	.197	5,0
		.295	7,5	.335	8,5	9068	9069	PR 161-295	.394	10,0						
		.059	1,5	.098	2,5	9070	9071	PR 201-059	.177	4,5						
		.098	2,5	.138	3,5	9072	9073	PR 201-098	.217	5,5						
.201	5,1	.138	3,5	.177	4,5	9074	9075	PR 201-138	.256	6,5	.087	2,2	.354	9,0	.197	5,0
		.177	4,5	.217	5,5	9076	9077	PR 201-177	.295	7,5						
		.217	5,5	.256	6,5	9078	9079	PR 201-217	.335	8,5						
		.256	6,5	.295	7,5	9080	9081	PR 201-256	.374	9,5						
		.295	7,5	.335	8,5	9082	9083	PR 201-295	.413	10,5						

Standard color black or white.

Heyco® Nylon Drive Rivets

MOUNTING HOLE DIAMETER		PANEL THICKNESS		PART NO.	DESCRIPTION	HEAD STYLE	PART DIMENSIONS									
							A Length		B Head Height		C Head Diameter		D Base Diameter			
in.	mm.	in.	mm.	Black		in.	mm.	in.	mm.	in.	mm.	in.	mm.			
.122	3,1	.118	3,0	.157	4,0	2576	DR 122-118	Binder	.217	5,5	.079	2,0	.220	5,6	.118	3,0
.161	4,1	.079	2,0	.118	3,0	2578	DR 161-079	Round	.177	4,5	.118	3,0	.315	8,0	.157	4,0
		.079	2,0	.118	3,0	2580	DR 201-079	Truss	.197	5,0						
		.118	3,0	.157	4,0	2582	DR 201-118	Binder	.236	6,0						
		.157	4,0	.197	5,0	2584	DR 201-157	Binder	.276	7,0	.110	2,8	.374	9,5	.197	5,0
.201	5,1	.197	5,0	.236	6,0	2586	DR 201-197	Binder	.315	8,0						
		.236	6,0	.276	7,0	2588	DR 201-236	Binder	.354	9,0						

Standard color black.